



## Ophthalmic Imaging Association

### Conference 2023 Delegate and Travel Information

Dear Conference delegates,

In preparation for our Annual Professional Conference 2023 and following our highly successful conference in Swindon last year, we are delighted to welcome you back. We are so grateful that you are supporting us by attending.

This short 'Delegate and Travel Information' document will, we hope, aid you in making arrangements when travelling to/from and attending Conference.

We recognise that Eastwood Hall is not very close to the centre of Nottingham, but it is an excellent venue for delegates and Trade supporters alike. The hotel is situated about 10 miles north-west of Nottingham's centre and mainline rail station. There is a branch rail stop (Erewash Valley Line) within Langley Mill, a taxi ride from the hotel. Alternatively, the hotel has ample free parking on-site as the hotel is only a mile or so north-east of the main A610 and less than 5 miles from the M1.

Enjoy the Conference and See You There!

Annual Conference : **27-28 October 2023**

(Trade set-up evening of Thursday 26<sup>th</sup> October – **no delegate access**, sorry)

Conference location:

Eastwood Hall  
Mansfield Road  
Eastwood, NOTTINGHAM  
NG16 3SS



Tel: 01773 532532 Web: [eastwood-hall.co.uk](http://eastwood-hall.co.uk)

For further information, please also see: <https://eyeimaging.org/>

Example taxis from Langley Mill station area to Eastwood Hall:

GT Taxis on 01773 300777 or Victoria Cars on 01773 787834

Location of Eastwood Hall relative to Nottingham

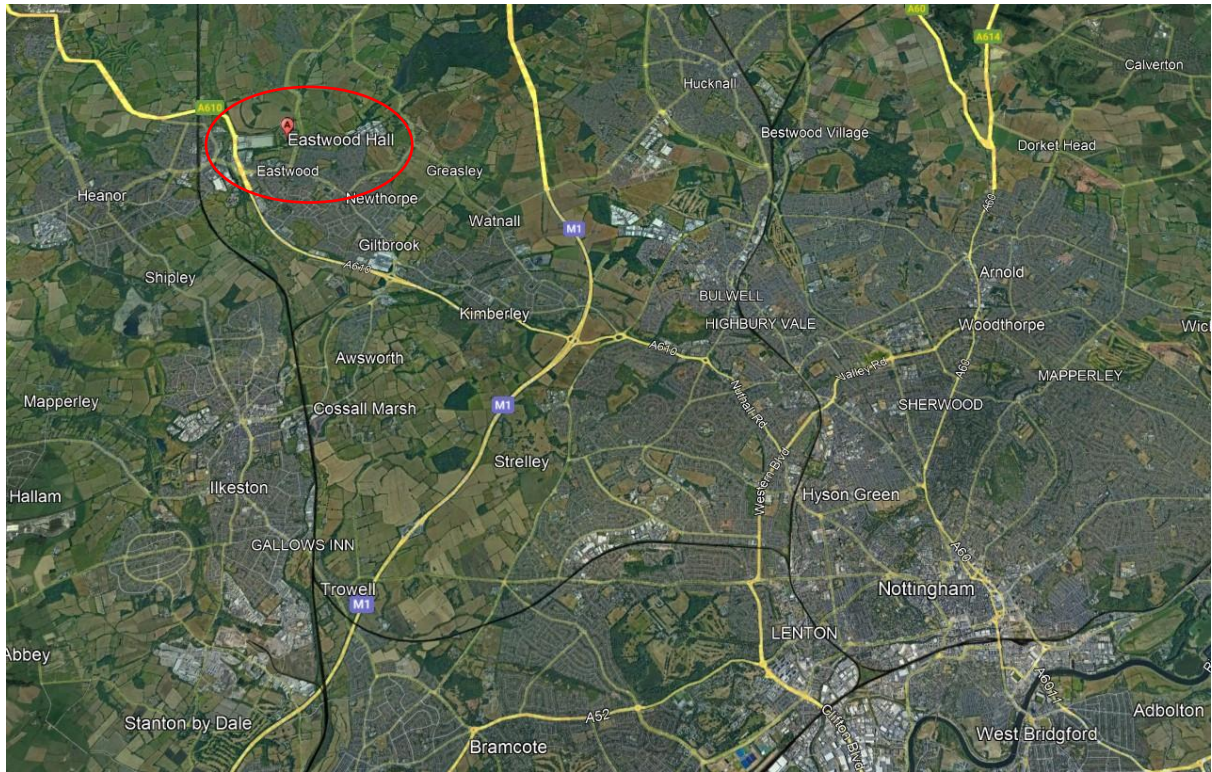

Suggested vehicle access route from M1 Junction 26, A610 to A608 (Mansfield Road) and Eastwood Hall



M1 Junction 26 to A610 (arrow 1)



A610 to A608 slip road & roundabout



A610 to A608 off roundabout (arrow 2)



A608 'deviation' in Eastwood (arrow 3)



Passing Morrisons on A608



A608 'deviation' in Eastwood (arrow 4)



Turning from A608 into Hotel complex



Hotel complex entrance



Delegate vehicle route to parking and pedestrian access/drop-off to Reception

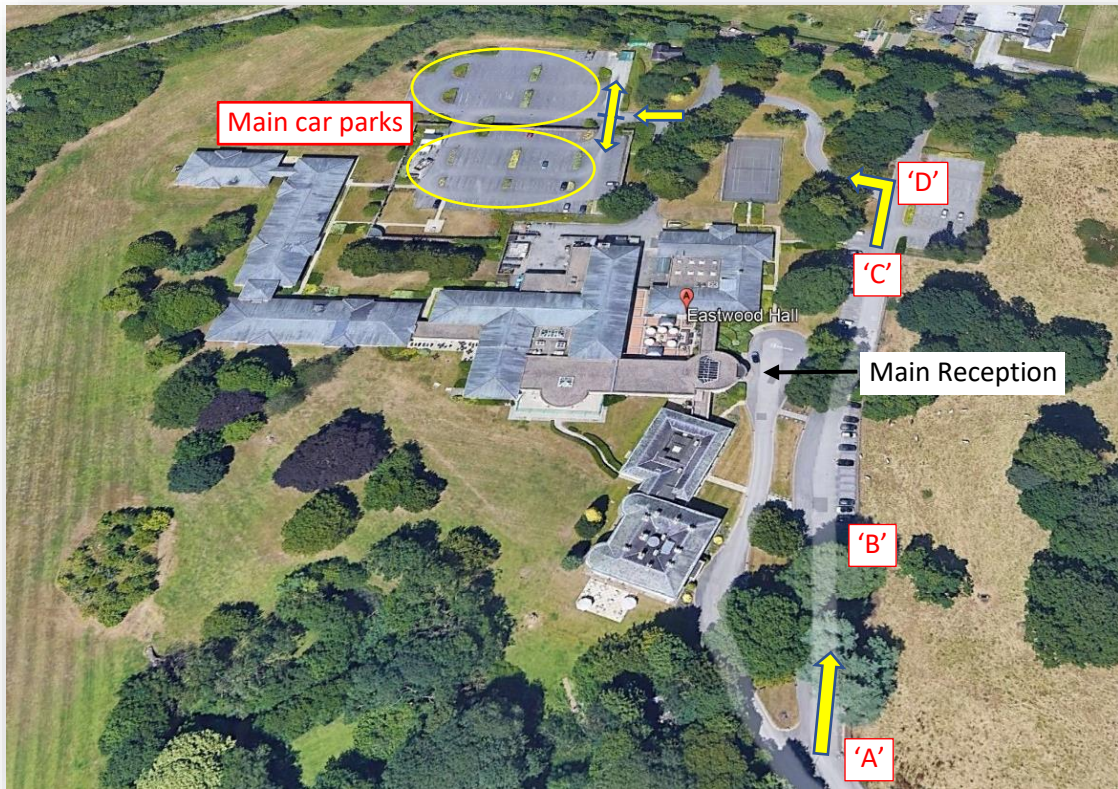

Location 'A'



Location 'B'



Location 'C'



Location 'D'



Notes to Conference Delegates:

1. We are delighted that you are able to join us at this year's annual Conference.
2. Access to the main Meeting and Trade Exhibition areas is on **Friday and Saturday only**. Please do not 'pop round' to have a look during the evening of Thursday (if you are staying that extra night), as there is a great deal of setting-up to do and you will be in the way!
3. Please make sure that you take every opportunity to visit our amazing Trade stand area as often as you can during Friday (from 08:30 to 17:00) and Saturday (from 08:30 to 14:00) and make yourself known to our wonderful Trade reps, who are supporting us again this year.
4. Note that refreshments and lunches will be served within that Trade Exhibition area during Conference, so we expect you to mingle and meet.
5. The more you participate, the more you and others will benefit from Conference.
6. The current draft Programme for Conference, the general layout of Eastwood Hall complex and the Trade Exhibition are provided below.
7. Once you have checked into your hotel bedrooms, you will have access to the rooms more directly from the car parks at the rear, via external doors, using your electronic keycards.
8. On Saturday, please ensure that you have cleared and checked-out of your rooms **before** attending the Conference sessions, as anyone 'over-staying' the stipulated check-out time will have to pay the hotel directly for that extra time. OIA will not cover those costs, sorry.
9. If you have any issues, please find one of the lovely people wearing one of our snazzy new 'OIA-logoed' black T-shirts.

OIA Committee are exceptionally grateful to you for attending Conference and we hope you enjoy it and find it worthwhile.

**Thank You!**

Overall layout of Eastwood Hall Hotel and Conference Centre complex

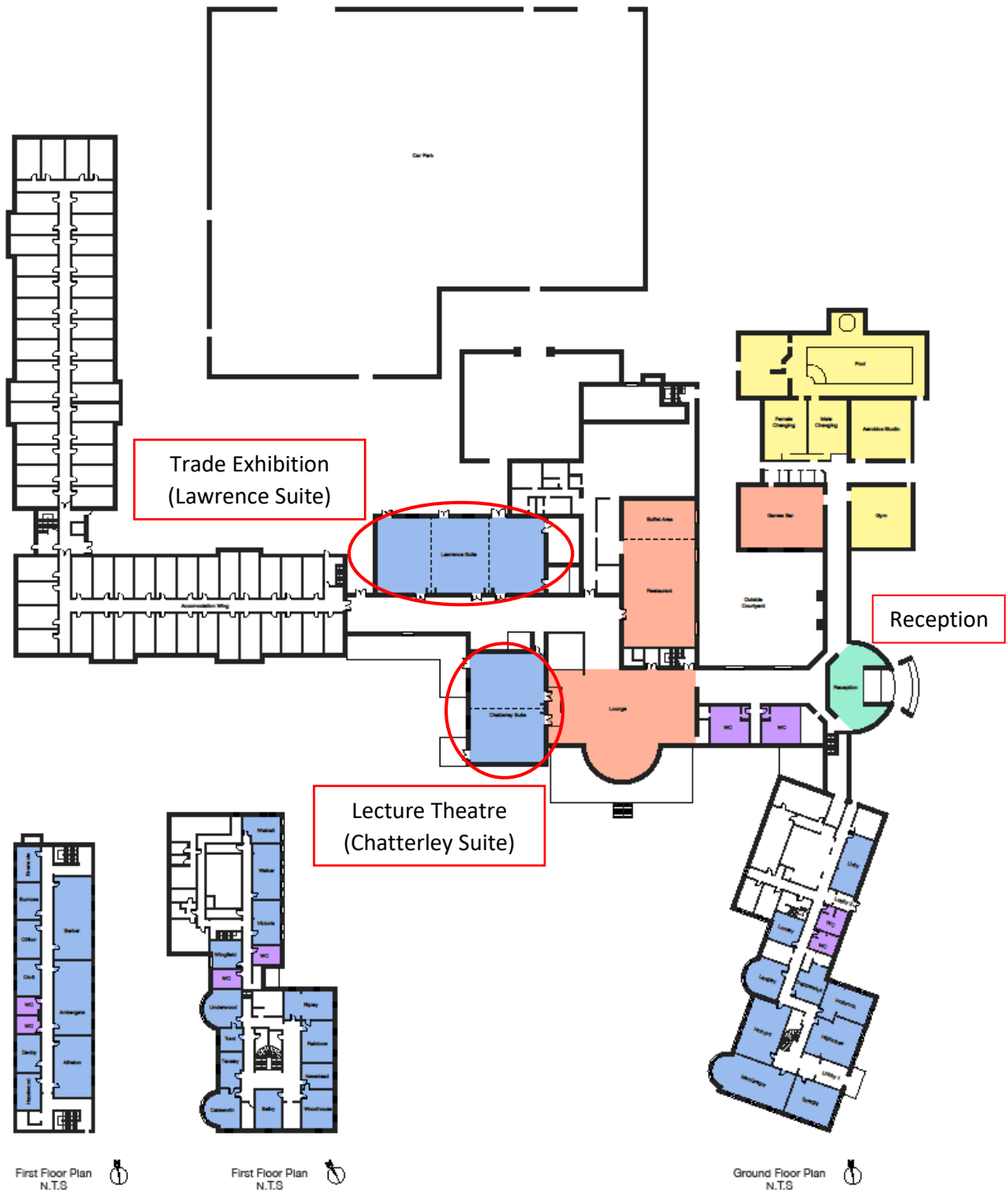

- Key:
- Reception
  - Meeting Rooms
  - Bar / Lounge / Restaurant
  - Leisure Facilities
  - Toilets

Current draft Programme (note – dates and times are subject to late changes)
--

<b>Friday 27<sup>th</sup> October</b>
---------------------------------------

Time	Topic	Speaker
From 8:30	Registration & Trade show opens	Refreshments provided
	Session 1 – Trade workshops	
09:00	Workshops session 1	
10:20	Refreshments in Trade Exhibition	
10:50	Workshop session 2	
12:10	Workshops session 3	
13:30	Lunch in Trade Exhibition	
	Session 2 – Lecture theatre	
14:10	Conference Opening	Rosalyn Painter (OIA Chair)
14:20	TBC	Emily Hogan, Nottingham
14:40	Do androids dream of electric eyes	Tim Cole, Heidelberg Engineering
15:00	TBC	Laura Pigula, Topcon
15:20	Refreshments in Trade Exhibition	
	Session 3 – Lecture theatre	
15:50	Research design/what happens to the data?	Charlotte Norridge & Julie Hapeshi, Gloucestershire
16:10	Medical Ethics	Alison Toop, Leeds University
16:30	TBC	Mr Simone Bruschi, Nottingham
17:00	AGM - Lecture Theatre (members only)	
19:00	Drinks Reception	
19:30	Conference Dinner & Awards Presentation	
21:00	Entertainment	

<b>Saturday 28<sup>th</sup> October</b>
---

Time	Topic	Speaker
From 8:30	Registration & Trade show opens	Refreshments provided
	Session 4 – Trade Updates	
09:00	Nicola Bennett – Keeler	
09:15	Tim Cole - Heidelberg Engineering	
09:30	TBC - Mainline	
09:45	TBC – Frost Optical	
10:00	Abdul Jahangir - Sense Medical & Canon	
10:15	Gemma Edwards - Haag-Streit	
10:30	Sundeep Rana - Topcon	
10:45	Adam Heritage - Zeiss	
11:00	Aidan - Daybreak	
11:15	TBC - Optos	
	Session 5 – Lecture Theatre	
11:30	New Voices	5x10min
12:20	Keynote address	Mr Elsherbiny South Warwickshire University NHSFT
13:00	Lunch in Trade Exhibition	
	Session 6 – Lecture theatre	
14:00	Ultra Widefield OCT	TBC, Sense Medical
14:20	Registration – Dissertation summary	Rosalyn Painter, Gloucestershire
14:40	Systemic disease and the eye – in animals	Dr John Mould, Eye Vet Clinic
15:10	TBC	Marika Toriani, Nottingham
15:30	TBC	Miss Niamh Stone (OIA President), Oxford
15:50	Closing remarks	Rosalyn Painter (OIA Chair)



Trade Exhibition partners



Look closer. See further.



Lawrence Suite - Trade Exhibition Layout

